

Alle Räume auf einen Blick

Overview of meeting rooms

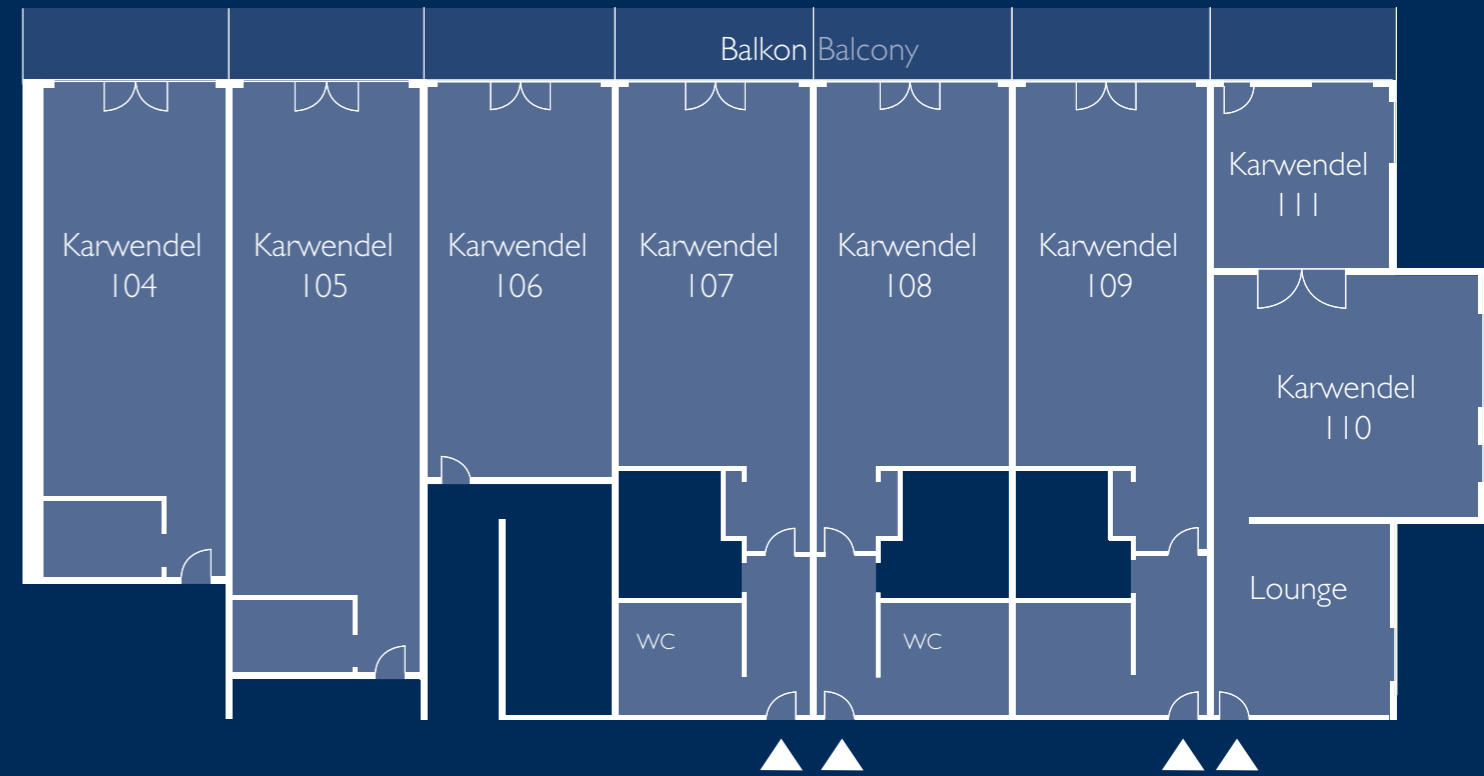

| Raum Room | Tagungsräume Conference rooms | | | | Bestuhlung – maximal Seating – maximum | | | |
|------------------------|----------------------------------|---------------------|--------------------|----------------|---|------------------------|--------------------|---|
| | Länge Length (m) | Breite Width (m) | Höhe Height (m) | m ² | Theater Theatre | Parlament Classroom | Block Boardroom | U-Form U-shape <small>außen bestuhlt chairs outside</small> |
| Innsbruck I | 13,2 | 9,8 | 3,1 – 3,4 | 130 | 140 | 70 | 45 | 35 |
| Innsbruck II | 13,2 | 9,9 | 3,1 – 3,4 | 130 | 140 | 70 | 45 | 35 |
| Innsbruck III | 13,2 | 9,5 | 3,1 | 125 | 130 | 60 | 40 | 35 |
| Innsbruck I + II | 19,8 | 13,2 | 3,1 – 3,4 | 261 | 280 | 150 | 75 | 60 |
| Innsbruck II + III | 19,5 | 13,2 | 3,1 – 3,4 | 257 | 260 | 140 | 70 | 55 |
| Innsbruck I + II + III | 29,4 | 13,2 | 3,1 – 3,4 | 388 | 400 | 250 | 100 | 80 |
| Leutasch | 13,7 | 9,3 – 12,3 | 2,8 | 133 | 130 | 70 | 45 | 35 |
| Telfs | 9,5 | 8,7 | 2,8 | 83 | 70 | 35 | 25 | 22 |
| Buchen | 8,3 | 4,7 | 2,8 | 39 | - | - | 14 | - |

| Raum Room | Besprechungsräume /-suite Break-out rooms / suite | | | | Bestuhlung – maximal Seating – maximum | | | |
|-------------------|--|---------------------|--------------------|----------------|---|------------------------|--------------------|---|
| | Länge Length (m) | Breite Width (m) | Höhe Height (m) | m ² | Theater Theatre | Parlament Classroom | Block Boardroom | U-Form U-shape <small>außen bestuhlt chairs outside</small> |
| Karwendel 104 | 10,6 | 4,7 | 2,4 | 52,7 | 42 | 25 | 27 | 25 |
| Karwendel 105 | 13,2 | 4,7 | 2,4 | 64,6 | 54 | 35 | 34 | 32 |
| Karwendel 106-109 | 8,5 | 4,6 | 2,4 | 40 | 30 | 20 | 14 | 12 |
| Karwendel 110/111 | 14,1 | 4,6 – 6,8 | 2,4 | 76 | - | - | 14 | - |